



Serie

Stilo - 76 RPT

Especificaciones Técnicas

Carpintería practicable con Rotura de Puente Térmico

Cámara Europea

Junta abierta con Junta Central

Sección de Marco 71 mm.

Sección de Hoja 76 mm.

Galce de vidrio de 7,5 a 54,5 mm.

Peso Máximo por : Hoja Practicable : 120 Kg.⁽¹⁾

Hoja Oscilo- Batiente : 130 Kg.⁽¹⁾

Hoja Oscilo- Batiente con opción de Herraje Oculto

Medidas Máximas por Hoja para todas las aperturas :

1700 mm. x 2500 mm.⁽¹⁾

(1) Consultar rangos de aplicación con nuestro Dpto. Técnico Comercial

Clasificación obtenida

Permeabilidad al aire*	CLASE 4
Estanqueidad al agua*	CLASE E1200
Resistencia al viento*	CLASE C5
Transmitancia térmica**	1,6 W(m ² K)
Aislamiento Acústico***	38 (-1;-5)dB

* Ventana de 2 hojas de 1230 x 1480 mm .

** Ventana de 2 hojas de 1480 x 2180 mm ; Vidrio Uv: 1,0 W(m²K)

*** Ventana de 2 hojas de 1230 x 1480 mm ; Vidrio Rw: 40 (-2,-6)dB

Posibilidades de Apertura

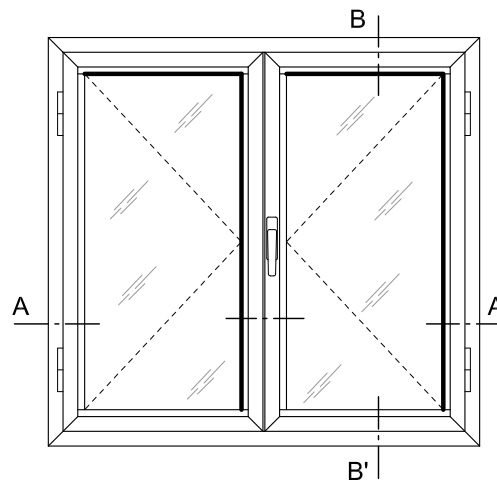
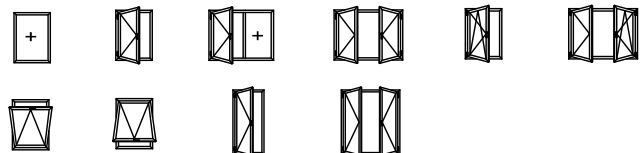

VENTANA 2 HOJAS PRACTICABLES

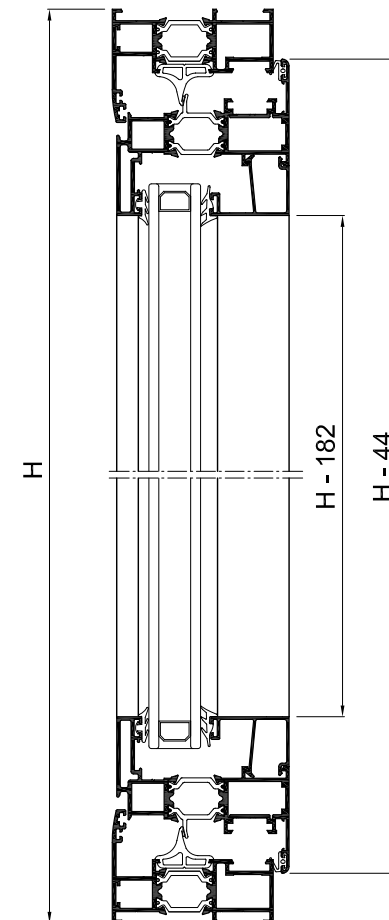

Sección B-B'

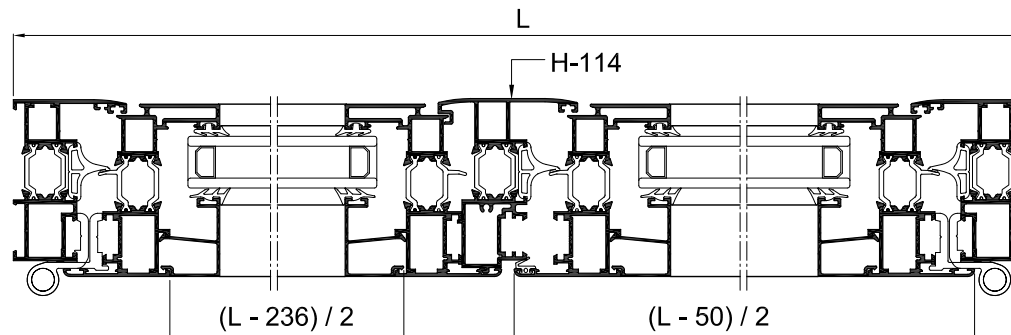

Sección A-A'

* Tabla de Junquillos 2 (Altura 22 mm)

Perfiles

Stilo - 76 RPT

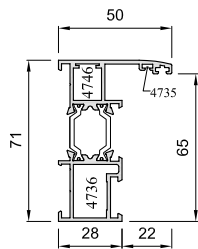

8600L

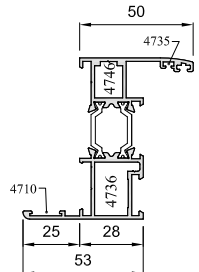

8628L

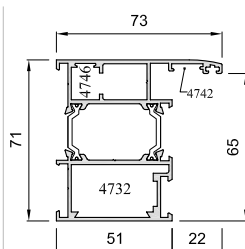

8616L

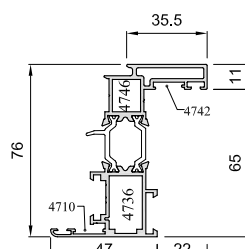

8631L

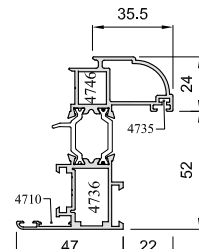

8602L

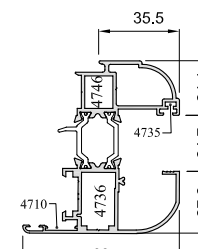

8623L

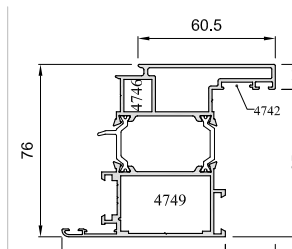

8632L

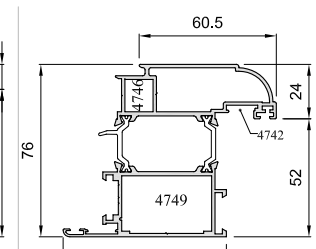

8618L

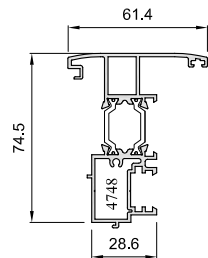

8609L

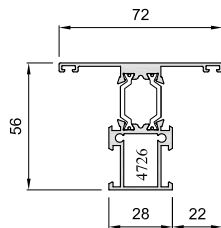

8605L

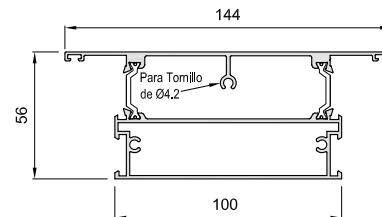

8889L

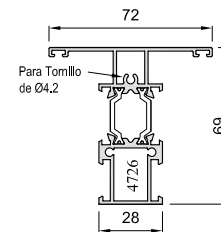

8604L

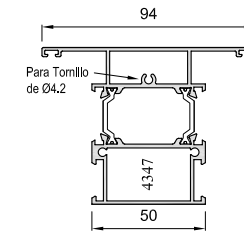

8607L

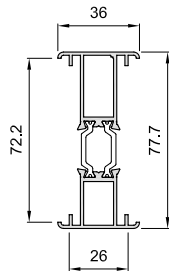

8098M

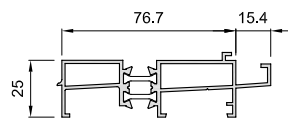

8619M

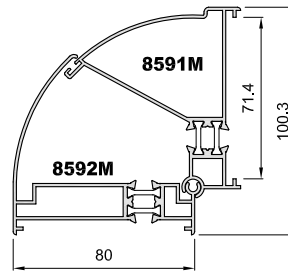

8592M

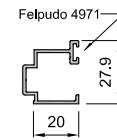

8891

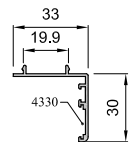

327
1144

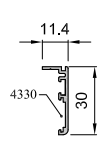

281
1140

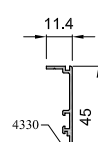

8629

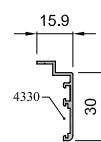

8832

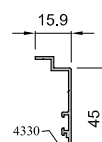

8630

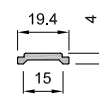

8412

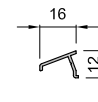

8428



Accesorios

Stilo - 76 RPT



4024
Cremona EURO



4019
Cremona EURO
Os-Ba

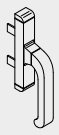

4200
Cremona
Nova



4316
Bisagra apertura
externa

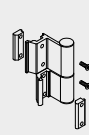

4390
Bisagra regleta
Ø 14 mm.



4724
Bisagra Os-Ba
Simétrica 2º Hoja



4739
Teminal pletina
metálico



4840
KIT Pasador hoja
pasiva metal.
(sup. e inf.)

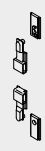

4025
Kit Cremona
EURO



4010
Bisagra compás
corto ralenti



4085
Bisagra compás
largo ralenti



4846
Tercer punto
de cierre



5002
Cierre suplem.
entre hojas



4720
Cerradero lateral
doble pletina
Zamak



4842
Cerradero sup.
regulable
OS-BA



4008
Patin apoyo hoja



4337
Embell. salida agua
c/ membrana



4736
Escuadra
ventana total



4746
2ª Escuadra
exterior ST



4742
Escuadra
alineamiento
excéntrica



4710
Escuadra
alineamien.
14 mm.



4735
Escuadra
alineamien.
2 mm.

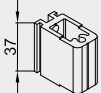

4347
Taco Stilo
pilastra ancha

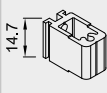

4726
Taco Stilo
pilastra 28 mm.

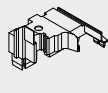

4748
Juego tapajuntas
acople



4747
Junta central



4839
Esquina Vulcanizada
Junta Central



4055
Junta perim.
hoja

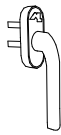

4833
Cremona
practicable cover



4834
Cremona os-ba
Cover



4725
Cremona Prima
Os-Ba



4096
Cremona Os-Pa
con llave



4398
Manilla
recuperable

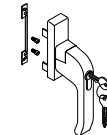

4707
Cremona EURO
c/ llave



4723
Cremona Prima

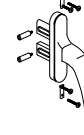

4737
Cremona ap. Ext.
patillas Balcon.



1044
Cierre presión
(Pequeño)



5079
Manilla inox.
recta



5080
Manilla inox
recta c/llave



5086
Manilla inox
recta acodada



4613
Mecanismo Cuadrad.
bidirec. practicable



5081
Mecanismo
Cuadrad. OS. BA.



4727
Bisagra Flash
Izquierda/Derecha

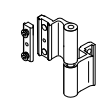

4768
Bisagra
3º Hoja

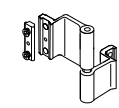

4769
Bisagra Extremo
"Jirafa"



4352
Bisagra ventana
3 hojas

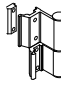

4389
Bisagra regleta
Ø 16 mm.



4744
Bisagra Puerta
24,5 mm. Izda.



4745
Bisagra Puerta
24,5 mm. Dcha.

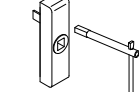

4079
Kit Cremona desmont.
Os-Pa > 2000 mm.

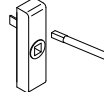

4365
Kit cremona desmont.
OS-PA < 2000 mm.



4002
Pasador oculto
long. variable



4003
Terminal de
pletina cremona



4007
Cierre complem.
cre mona



4011
Bisagra compás regul.
proyectante



4009
Cierre cangrejo
Interno



4366
Cierre bisagra
oculta



4035
Embellecedor
salida agua



4754
Retenedor
de hoja



4848
Microventilacion
practicable



5026
Bulón regulable



4005
Cerradero lateral
pletina Nylon

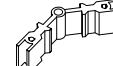

4708
Escuadra ángulo
variable



4004
Cerradero lateral
doble pletina. Nylon



4078
Pieza sujeción
junquillo curvo



4391
Escuadra
junquillos curvos



4043
Juego tapas
condensación

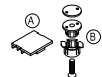

(2 A + 2 B)
4353
Kit acristalami.
s/junquillo



4198
Junta acústica
cerco



4039
Escuadra inox.
alineamiento



4304
Escuadra
alineam. solapas



4330
Escuadra alineamien.
15 mm.



4855
Escuadra solapa
8893



4089
Goma interior
acrist. de 2 a 4
mm.



4090
Goma interior
acrist. de 4 a 6
mm.



4091
Goma Interior
acrist. de 6 a 8
mm.



4057
Goma exterior
acristalamiento



4056
Junta perimetral
hoja "TC"



4397
Junta Stilo
base rígida

Accesorios Varios

- 4025 Kit Cremona EURO
- 4380 Kit Cremona EURO 2 hojas (sin cremona)
4002x2 + 4003x2 + 4025 + 4004x2 + 4008
- 4714 Kit Cremona EURO 1 hoja
4003x2 + 4025 + 4005x2
- 4201 Kit Cremona Nova
- 4753 Cerradura Standard E=25
- 4335 Ruleta para goma
- 4750 Fresa Cerco ST-76 RPT
- 4751 Fresa Hoja ST-76 RPT
- 4334 Tijeras ingletes goma
- 4752 Util Stilo-76
- 5022 Cremona Industrial Prima
- 5023 Cremona Industrial Euro
- 5024 Herraje Os-Ba Industrial

